

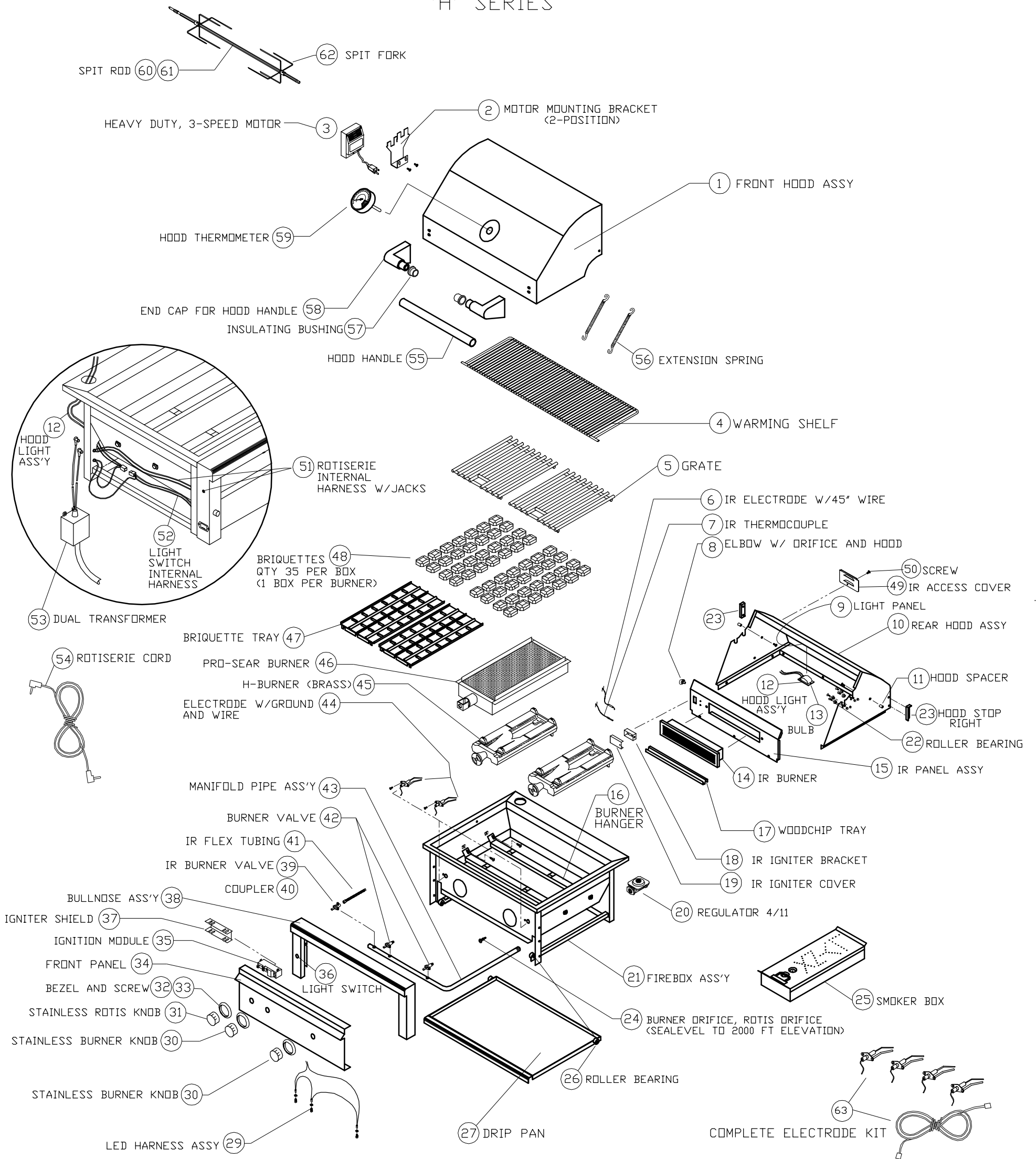

2006 PROFESSIONAL SERIES  
'H' SERIES



2006 PROFESSIONAL SERIES PARTS LIST  
'H' SERIES

ITEM	GRILL SIZE	PART NO.	DESCRIPTION
1	L27	80245	FRONT HOOD ASSY, 27"
	L30	80208	FRONT HOOD ASSY, 30"
	L36	80224	FRONT HOOD ASSY, 36"
	L42	80198	FRONT HOOD ASSY, 42"
	L54	80217	FRONT HOOD ASSY, 54"
2	30,36,42,54	31027	MOTOR MOUNTING BRACKET,30",36",42",54"
	L27	30394	MOTOR MOUNTING BRACKET, 27"
3	30,36,42,54	80545	HEAVY DUTY, 3-SPEED MOTOR,30",36",42",54"
	L27	32679	HEAVY DUTY, 2-SPEED MOTOR, 27"
4	L27	20066	WARMING SHELF, 27"
	L30	20067	WARMING SHELF, 30"
	L36	31569	WARMING SHELF, 36"
	L42	20069	WARMING SHELF, 42"
	L54	31418	WARMING SHELF, 54"
5	L27	17012	(2) GRATES- 12" x 18"
	L30	30018	(2) GRATES- 13 1/2" X 21"
	L36	17020	(2) GRATES- 16 1/2" X 18 1/2"
	L42	30018	(2) GRATES- 13 1/2" X 21"
		30019	(1) GRATE- 12" X 21" (CENTER)
	L54	30018	(2) GRATES- 13 1/2" X 21"
		30019	(2) GRATES- 12" X 21"
6	ALL	31173	IR ELECTRODE W/ 45" WIRE
7	ALL	20018	THERMOCOUPLE
8	ALL	13009	ELBOW W/ DRIFICE AND HOOD
9	L30	18010	LIGHT PANEL/REAR HOOD LINER, 30"
	L36	31490	LIGHT PANEL/REAR HOOD LINER, 36"
	L42	18011	LIGHT PANEL/REAR HOOD LINER, 42"
	L54	31328	LIGHT PANEL/REAR HOOD LINER, 54"
10	L27	80176	REAR HOOD ASSY, 27"
		80061	REAR HOOD ASSY, 27" NON-IR
	L30	80209	REAR HOOD ASSY, 30"
	L36	80225	REAR HOOD ASSY, 36"
	L42	80199	REAR HOOD ASSY, 42"
	L54	80218	REAR HOOD ASSY, 54"
11	30,36,42,54	20054	HOOD SPACER, 30", 36", 42", 54"
	L27	10146	HOOD SPACER, 27"
12	30,36,42	80134	HOOD LIGHT ASSY W/10W BULB, 30",36",42"
	L54	80196	HOOD LIGHT ASSY, DUAL 5W LIGHTS, 54"
13	27,30,36,42	31979	BULB, REPLACEMENT, 10W HALOGEN
	ALL	32322	GLASS REPLACEMENT COVER W/ CLIP
	L54	31070	BULB, REPLACEMENT, 5W HALOGEN, 54"
14	L27	11168	IR BURNER (16") FOR 27"
	30,36,54	11169	IR BURNER (21") FOR 30", 36", 54"
	L42	30179	IR BURNER (28") FOR 42"
15	L27	80003	IR PANEL ASSY, 27"
	L30	80125	IR PANEL ASSY, 30"
	30 NON-IR	80116	REAR PANEL ASSY, 30"
	L36	80186	IR PANEL ASSY, 36"
	L42	80130	IR PANEL ASSY, 42"
	L54	80167	IR PANEL ASSY, 54"
16	L27	10067	BURNER HANGER, 27"
	L30	31527	BURNER HANGER, 30"
	L36	31577	BURNER HANGER, 36"
	L42	31758	BURNER HANGER, 42"
	L54	31333	BURNER HANGER, 54"
17	27,30,54	10159	WOODCHIP TRAY (27", 30", 54")
	36,42	10158	WOODCHIP TRAY (36", 42")
18	ALL	10008	IR IGNITER BRACKET
19	30	31244	IR IGNITER COVER (30")
	27,36,42,54	10043	IR IGNITER COVER (27", 36", 42", 54")
20	ALL	30781	REGULATOR 4/11 N/G ONLY
	27,30	13026	REGULATOR W/36" HOSE SINGLE STAGE
	36,42,54	13053	REGULATOR W/30" HOSE DOUBLE STAGE
21	L27	80004	FIREBOX ASSY, 27"
	L30	80207	FIREBOX ASSY, 30"
		80158	FIREBOX ASSY, 30" PROSEAR POD
	L36	80223	FIREBOX ASSY, 36"
	L42	80197	FIREBOX ASSY, 42"
	L54	80216	FIREBOX ASSY, 54"
22	ALL	20055	ROLLER BEARING
	ALL	31804	SPIT BEARING SCREW, #8-32x5/8 PH FLAT
	ALL	31805	SPIT BEARING NUT, ACDORN, #8-32
23	ALL	31801	HOOD STOP, EXTENDED, RIGHT
	ALL	31802	HOOD STOP, EXTENDED, LEFT
24	L27,L36	13013	DRIFICE,BURNER, NG (#41 SHORT)
	L27,L36	13019	DRIFICE,BURNER, LP (#53 SHORT)
	30,42,54	30329	DRIFICE,BURNER, NG (#41 LONG)
	30,42,54	30328	DRIFICE,BURNER, LP (#53 LONG)
	PROSEAR	13015	DRIFICE,BURNER, NG (#44 SHORT)
	PROSEAR	13020	DRIFICE,BURNER, LP (#54 SHORT)
	30,36,54	13016	DRIFICE, IR ROTIS., NG (#50 SHORT)
	30,36,54	13021	DRIFICE, IR ROTIS., LP (#57 SHORT)
	L27"	13016	DRIFICE, IR ROTIS., NG (#50 SHORT)
	L27"	13021	DRIFICE, IR ROTIS., LP (#57 SHORT)
	L42"	30470	DRIFICE, IR ROTIS., NG (#48 SHORT)
	L42"	31342	DRIFICE, IR ROTIS., LP (#56 SHORT)
25	30,42,54	90073	SMOKER BOX ASSY 30", 42", 54"
	27,36	90074	SMOKER BOX ASSY, 27", 36"
26	ALL	20055	ROLLER BEARING
	ALL	14099	ROLLER BEARING SCREW,#10-24x3/4 PH FLAT
	ALL	20083	ROLLER BEARING NUT, #10-24 HEX
27	L27	31421	DRIP PAN, 27"
	L30	18050	DRIP PAN, 30"
	L36	31494	DRIP PAN, 36"
	L42	18051	DRIP PAN, 42"
	L54	31324	DRIP PAN, 54"
28	ALL	31879	BATTERY HOLDER ASSY W/ DIODE
	36,42	31459	BATTERY EXTENSION WIRE, 36", 42"
	L54	31461	BATTERY EXTENSION WIRE, 54"
29	L30	80236	LED HARNESS ASSY, 30"
	L36	80373	LED HARNESS ASSY, 36"
	L42	80235	LED HARNESS ASSY, 42"
	L54	80237	LED HARNESS ASSY, 54"
	ALL	32554	LED HOLDER

ITEM	GRILL SIZE	PART NO.	DESCRIPTION
30	ALL	90137	STAINLESS BURNER KNOB, ALL SIZES
31	ALL	90136	STAINLESS IR ROTIS. KNOB, ALL SIZES
	ALL	90139	STAINLESS KNOB KIT (3 BURNER+1 ROTIS)
32	ALL	10001	BEZEL
33	ALL	31929	BEZEL SCREW, #6-32 X 1/8 PH PAN
34	L27	31438	FRONT PANEL, 27"
		31441	FRONT PANEL, 27", NON-IR
	L30	31670	FRONT PANEL, 30"
		31787	FRONT PANEL, 30" PROSEAR
		31288	FRONT PANEL, 30" PROSEAR POD
	L36	31682	FRONT PANEL, 36"
		31789	FRONT PANEL, 36" PROSEAR
	L42	31687	FRONT PANEL, 42"
		31790	FRONT PANEL, 42" PROSEAR
	L54	31691	FRONT PANEL, 54"
35	ALL	31161	IGNITION MODULE (4-SPARK)
	L54	31162	IGNITION MODULE (2-SPARK) 54"
36	ALL	80206	LIGHT SWITCH + COMPLETE HARNESS
	ALL	20078	LIGHT SWITCH ONLY
37	ALL	31398	IGNITER SHIELD
38	L27	80174	BULLNOSE ASSY, 27"
	L30	80210	BULLNOSE ASSY, 30"
		80246	BULLNOSE ASSY, 30" PROSEAR POD
	L36	80226	BULLNOSE ASSY, 36"
	L42	80205	BULLNOSE ASSY, 42"
	L54	80219	BULLNOSE ASSY, 54"
39	ALL	31772	IR BURNER VALVE W/ MICROSWITCH
40	L27	31065	COUPLER, 27" ONLY
41	ALL	31794	FLEX HOSE, 9 MM X 38" W/ 7/16 FITTINGS
42	ALL	32846	MAIN BURNER VALVE W/ MICROSWITCH
	ALL	32845	MICROSWITCH REPLACEMENT FOR VALVE
43	L27	80251	MANIFOLD ASSY W/VALVES, 27" LP
	L27	80252	MANIFOLD ASSY W/VALVES, 27" LP NON IR
	L27	80253	MANIFOLD ASSY W/VALVES, 27" NG
	L27	80254	MANIFOLD ASSY W/VALVES, 27" NG NON IR
	L30	80211	MANIFOLD ASSY W/VALVES, 30" LP PROSEAR
	L30	80212	MANIFOLD ASSY W/VALVES, 30" LP
	L30	80213	MANIFOLD ASSY W/VALVES, 30" NG PROSEAR
	L30	80214	MANIFOLD ASSY W/VALVES, 30" NG
	L36	80227	MANIFOLD ASSY W/VALVES, 36" LP PROSEAR
	L36	80228	MANIFOLD ASSY W/VALVES, 36" LP
	L36	80229	MANIFOLD ASSY W/VALVES, 36" NG PROSEAR
	L36	80230	MANIFOLD ASSY W/VALVES, 36" NG
	L42	80201	MANIFOLD ASSY W/VALVES, 42" LP PROSEAR
	L42	80202	MANIFOLD ASSY W/VALVES, 42" LP
	L42	80203	MANIFOLD ASSY W/VALVES, 42" NG PROSEAR
	L42	80204	MANIFOLD ASSY W/VALVES, 42" NG
	L54	80220	MANIFOLD ASSY W/VALVES, 54" LP PROSEAR
	L54	80221	MANIFOLD ASSY W/VALVES, 54" NG PROSEAR
44	30,36,42,54	31254	ELECTRODE, GROUNDED, W/15" WIRE
	30,36,42,54	31255	ELECTRODE, GROUNDED, W/25" WIRE
	ALL P/S	31807	ELECTRODE, PROSEAR W/ 34" WIRE
	L27	31217	ELECTRODE W/ 15" WIRE, 27" ONLY
	L27	31218	ELECTRODE W/ 25" WIRE, 27" ONLY
	L27	10077	GAS COLLECTOR BOX, 27" ONLY
	L27	14018	SCREW FOR COLLECTOR BOX,#6-32 x 1/4"
45	30,42,54	30485	H-BURNER (BRASS)
	27,36	11012	H-BURNER (BRASS)
46	PS MODELS	31885	PROSEAR BURNER, 30", 42", 54"
	PS MODELS	31256	SCREEN REPLACEMENT, PROSEAR BURNER
	36 PS	32915	PROSEAR BURNER, PRO 36"
	36 PS	32243	SCREEN REPLACEMENT, 36" PROSEAR BURNER
47	30,42,54	80015	BRIQUETTE TRAY, 30", 42", 54"
	30,42,54	80364	COMPLETE TRAY W/ BRIQUETTES & CLIPS
	42,54	80033	BRIQUETTE TRAY, NARROW, 42",54"
	42,54	80365	COMPLETE TRAY W/ BRIQUETTES & CLIPS
	27,36	80232	BRIQUETTE TRAY, 27", 36"
	27,36	80363	COMPLETE TRAY W/ BRIQUETTES & CLIPS
48	ALL	90053	BRIQUETTES, 35 PER BOX
49	ALL	30417	IR ACCESS COVER
50	ALL	14012	SCREW, 1/4-20 X 3/8 PH TRUSS HD, S/S
51	ALL	80136	ROTISERIE INTERNAL HARNESS W/JACKS
52	ALL	80206	LIGHT SWITCH INTERNAL HARNESS + SWITCH
53	ALL	31209	DUAL TRANSFORMER
54	ALL	31170	ROTISERIE EXTERNAL CORD
55	L27	10063	HOOD HANDLE, 27"
	L30	31767	HOOD HANDLE, 30"
	L36	31768	HOOD HANDLE, 36"
	L42	31769	HOOD HANDLE, 42"
	L54	31770	HOOD HANDLE, 54"
56	30,42,54	31874	EXTENSION SPRING, 30", 42", 54"
	L36	31780	EXTENSION SPRING, 36"
57	30,36,42,54	31738	INSULATING BUSHING, HOOD HANDLE
58	30,36,42,54	31736	END CAP FOR HOOD HANDLE
	L27	11117	END CAP FOR HOOD HANDLE, 27"ONLY
	L27	20016	INSULATOR FOR HOOD HANDLE, 27"ONLY
59	ALL	31200	HOOD THERMOMETER
60	L27	30756	SPIT ROD, 27" ONLY
	L27	20014	SPIT ROD HANDLE, 27" (NOT SHOWN)
61	L30	31694	SPIT ROD, 30"
	L36	31695	SPIT ROD, 36"
	L42	31696	SPIT ROD, 42"
	L54	31697	SPIT ROD, 54"
62	L27	31067	SPIT FORK, 27" ONLY
	30,36,42,54	31563	SPIT FORK, HEAVY DUTY, 30,36,42,54
63	L27	80143	ELECTRODE KIT, 27" NON-IR
	L27R	80144	ELECTRODE KIT, 27"
	L30R	80215	ELECTRODE KIT, 30"
	L30PSP	80154	ELECTRODE KIT, 30" ALL-PROSEAR & POD
	L36R	80231	ELECTRODE KIT, 36"
	L42R	80200	ELECTRODE KIT, 42"
	L54PSR	80222	ELECTRODE KIT, 54" PROSEAR