

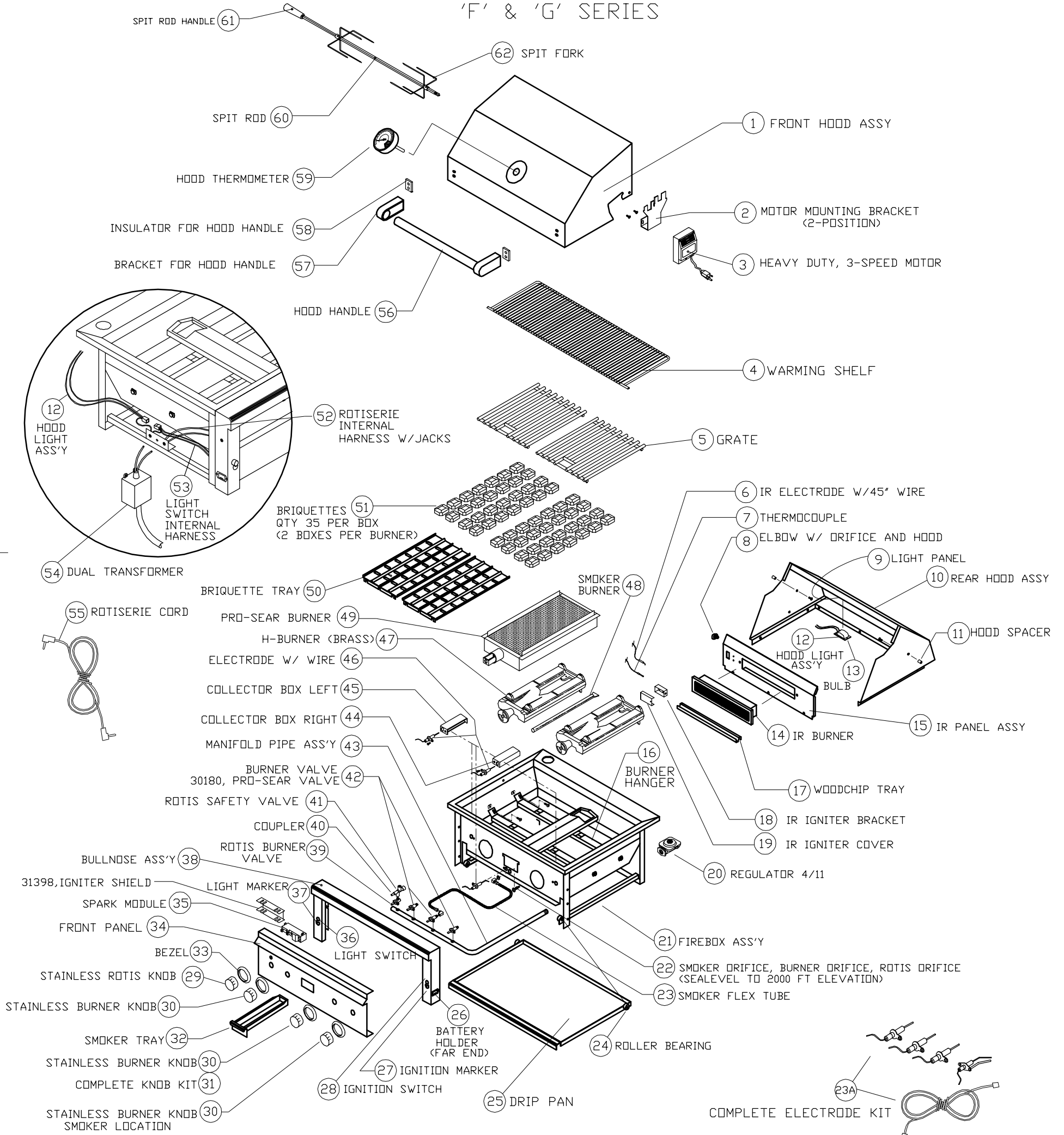

2005 PROFESSIONAL SERIES  
'F' & 'G' SERIES



# 2005 PROFESSIONAL SERIES PARTS LIST 'F' & 'G' SERIES

ITEM	GRILL SIZE	PART NO.	DESCRIPTION	ITEM	GRILL SIZE	PART NO.	DESCRIPTION
1	L27	80001	FRONT HOOD ASSY, 27"	25	L27	31421	DRIP PAN, 27"
	L30	80123	FRONT HOOD ASSY, 30"		L30	18050	DRIP PAN, 30"
	L36	80188	FRONT HOOD ASSY, 36"		L36	31494	DRIP PAN, 36"
	L42	80128	FRONT HOOD ASSY, 42"		L42	18051	DRIP PAN, 42"
	L54	80165	FRONT HOOD ASSY, 54"		L54	31324	DRIP PAN, 54"
	L54/30	80123	FRONT HOOD ASSY, 30"		L54/30	18050	DRIP PAN, 30"
2	30,36,42,54	31027	MOTOR MOUNTING BRACKET,30",36",42",54"	26	ALL	31879	BATTERY HOLDER ASS'Y W/ DIODE
	L27	30394	MOTOR MOUNTING BRACKET, 27"		36,42	31459	BATTERY EXTENSION WIRE, 36", 42"
3	30,36,42,54	80545	HEAVY DUTY, 3-SPEED MOTOR,30",36",42",54"		L54	31461	BATTERY EXTENSION WIRE, 54"
	L27	32679	HEAVY DUTY, 2-SPEED MOTOR	27	ALL	31365	IGNITION MARKER (30", 36", 42" 54")
4	L27	20066	WARMING SHELF, 27"	28	ALL	20079	IGNITION SWITCH
	L30	20067	WARMING SHELF, 30"	29	ALL	90136	STAINLESS IR ROTIS. KNOB, ALL SIZES
	L36	31597	WARMING SHELF, 36"	30	ALL	90137	STAINLESS BURNER KNOB, ALL SIZES
	L42	20069	WARMING SHELF, 42"	31	ALL	90139	STAINLESS KNOB KIT (3 BURNER+1 ROTIS)
	L54	31418	WARMING SHELF, 54"	32	30,42,54	80051	SMOKER TRAY ASSY (30",42",54")
	L54/30	20067	WARMING SHELF, 30"		L36	80191	SMOKER TRAY ASSY (36")
5	L27	17012	(2) GRATES- 12" X 18"		L27	80050	SMOKER TRAY ASSY (27")
	L30	30018	(2) GRATES- 13 1/2" X 21"	33	ALL	10001	BEZEL
	L36	17020	(2) GRATES- 16 1/2" X 18 1/2"	34	L27	31438	FRONT PANEL, 27"
	L42	30018	(2) GRATES- 13 1/2" X 21"		27 NO IR	31441	FRONT PANEL, 27", NON-IR
		30019	(1) GRATE- 12" X 21" (CENTER)		L30	18045	FRONT PANEL, 30"
	L54	30018	(2) GRATES- 13 1/2" X 21"			31090	FRONT PANEL, 30" NON-IR
		30019	(2) GRATES- 12" X 21"			31524	FRONT PANEL, 30" PROSEAR-SINGLE
	L54/30	30018	(2) GRATES- 13 1/2" X 21"			31189	FRONT PANEL, 30" PROSEAR-DOUBLE
6	ALL	31173	IR ELECTRODE W/ 45" WIRE			31288	FRONT PANEL, 30" PROSEAR POD
7	ALL	20018	THERMOCOUPLE		L36	31496	FRONT PANEL, 36"
8	ALL	13009	ELBOW W/ ORIFICE AND HOOD		L42	18046	FRONT PANEL, 42"
9	L30	18010	LIGHT PANEL/REAR HOOD LINER, 30"			31314	FRONT PANEL, 42" PROSEAR
	L36	31490	LIGHT PANEL/REAR HOOD LINER, 36"		L54	31323	FRONT PANEL, 54" PROSEAR
	L42	18011	LIGHT PANEL/REAR HOOD LINER, 42"			18047	FRONT PANEL, 54/30"
	L54	31328	LIGHT PANEL/REAR HOOD LINER, 54"	35	ALL	31161	SPARK MODULE (4-SPARK)
	L54/30	18010	LIGHT PANEL/REAR HOOD LINER, 54/30"		36,42	31162	SPARK MODULE (2-SPARK) 36",42"
10	L27	80176	REAR HOOD ASSY, 27"	36	ALL	20078	LIGHT SWITCH (30",36",42",54")
		80061	REAR HOOD ASSY, 27" NON-IR	37	ALL	31364	LIGHT MARKER (30", 36", 42", 54")
	L30	80124	REAR HOOD ASSY, 30"	38	L27	80174	BULLNOSE ASS'Y, 27"
	L36	80189	REAR HOOD ASSY, 36"		L30	80172	BULLNOSE ASS'Y, 30"
	L42	80129	REAR HOOD ASSY, 42"			80159	BULLNOSE ASS'Y, 30" PROSEAR POD
	L54	80166	REAR HOOD ASSY, 54"		L36	80187	BULLNOSE ASS'Y, 36"
	L54/30	80124	REAR HOOD ASSY, 30"		L42	80173	BULLNOSE ASS'Y, 42"
11		20054	HOOD SPACER, 30", 36", 42", 54", 54/30"		L54	80111	BULLNOSE ASS'Y, 54" AND 54/30"
	L27	10146	HOOD SPACER, 27"	39	ALL	31142	IR ROTIS BURNER VALVE
12	30,36,42,54,30	80134	HOOD LIGHT ASS'Y, 30",36",42",54/30"	40	ALL	31065	COUPLER
	L54	80196	HOOD LIGHT ASS'Y, DUAL LIGHTS, 54"	41	ALL	31058	IR ROTIS SAFETY VALVE
12A	ALL	32322	GLASS REPLACEMENT COVER W/CLIP	42	ALL	31442	BURNER VALVE
13	ALL	31070	BULB, HALOGEN	43	L27	80009	MANIFOLD ASS'Y W/VALVES, 27" LP
14	L27	11168	IR BURNER (16") FOR 27"		L27	80037	MANIFOLD ASS'Y W/VALVES, 27" LP NON IR
	30,36,54	11169	IR BURNER (21") FOR 30", 36", 54"		L27	80091	MANIFOLD ASS'Y W/VALVES, 27" NG
	L42	30179	IR BURNER (28") FOR 42"		L27	80096	MANIFOLD ASS'Y W/VALVES, 27" NG NON IR
15	L27	80003	IR PANEL ASSY, 27"		L30	80181	MANIFOLD ASS'Y W/VALVES, 30" LP PROSEAR
	L30	80125	IR PANEL ASSY, 30"		L30,5430	80018	MANIFOLD ASS'Y W/VALVES, 30" LP
	30 NON-IR	80116	REAR PANEL ASSY, 30"		L30	80182	MANIFOLD ASS'Y W/VALVES, 30" NG PROSEAR
	L36	80186	IR PANEL ASSY, 36"		L30,5430	80092	MANIFOLD ASS'Y W/VALVES, 30" NG
	L42	80130	IR PANEL ASSY, 42"		L5430	80110	MANIFOLD ASS'Y W/VALVES, 54/30 SIDEBURNER
	L54	80167	IR PANEL ASSY, 54"		L30 NON-IR	80117	MANIFOLD ASS'Y W/VALVES, 30" NON-IR LP
	L54/30	80125	IR PANEL ASSY, 30"		L30 NON-IR	80118	MANIFOLD ASS'Y W/VALVES, 30" NON-IR NG
16	L27	10067	BURNER HANGER, 27"		L30 ALL P/S	80150	MANIFOLD ASS'Y W/VALVES, 30" ALL P/S LP
	L30	18021	BURNER HANGER, 30"		L30 ALL P/S	80151	MANIFOLD ASS'Y W/VALVES, 30" ALL P/S NG
		31527	BURNER HANGER, 30" PROSEAR-SINGLE		L36	80027	MANIFOLD ASS'Y W/VALVES, 36" LP PREMIER
	L36	31577	BURNER HANGER, 36"		L36	80195	MANIFOLD ASS'Y W/VALVES, 36" LP
	L42	30436	BURNER HANGER, 42"		L36	80093	MANIFOLD ASS'Y W/VALVES, 36" NG PREMIER
	L54	31333	BURNER HANGER, 54"		L36	80194	MANIFOLD ASS'Y W/VALVES, 36" NG
	L54/30	18021	BURNER HANGER, 54/30"		L42	80152	MANIFOLD ASS'Y W/VALVES, 42" LP PROSEAR
17	27,30,54,5430	10159	WOODCHIP TRAY (27", 30", 54" 54/30")		L42	80036	MANIFOLD ASS'Y W/VALVES, 42" LP
	36,42	10158	WOODCHIP TRAY (36", 42")		L42	80153	MANIFOLD ASS'Y W/VALVES, 42" NG PROSEAR
18	ALL	10008	IR IGNITER BRACKET		L42	80094	MANIFOLD ASS'Y W/VALVES, 42" NG
19	30,5430	31244	IR IGNITER COVER (30", 54/30")		L54	80168	MANIFOLD ASS'Y W/VALVES, 54" LP PROSEAR
	27,36,42,54	10043	IR IGNITER COVER (27", 36", 42", 54")		L54	80169	MANIFOLD ASS'Y W/VALVES, 54" NG PROSEAR
20	ALL	30781	REGULATOR 4/11 N/G ONLY	44	30,42,54	18033	GAS COLLECTOR BOX RIGHT
	27,30,5430	13026	REGULATOR W/36" HOSE SINGLE STAGE	45	30,42,54	31030	GAS COLLECTOR BOX LEFT
	36,42,54	13053	REGULATOR W/30" HOSE DOUBLE STAGE	46	30,42,54	31220	ELECTRODE W/ 15" WIRE
21	L27	80004	FIREBOX ASSY, 27"		30,42,54	31221	ELECTRODE W/ 25" WIRE
	L30	80013	FIREBOX ASSY, 30"		30,36,42,54	31222	SMOKER ELECTRODE, 30",36",42",54",54/30"
		80183	FIREBOX ASSY, 30" PROSEAR-SINGLE		P/S 30,42,54	31254	PROSEAR ELECTRODE W/ 15" WIRE
		80122	FIREBOX ASSY, 30" PROSEAR-DOUBLE		P/S 30	31255	PROSEAR ELECTRODE W/ 25" WIRE
		80158	FIREBOX ASSY, 30" PROSEAR POD		P/S 54	31455	PROSEAR ELECTRODE RIGHT HAND, 54"
	L36	80190	FIREBOX ASSY, 36"		27,36	31217	ELECTRODE W/ 15" WIRE, 27",36" ONLY
	L42	80031	FIREBOX ASSY, 42"		27,36	31218	ELECTRODE W/ 25" WIRE, 27",36" ONLY
		80137	FIREBOX ASSY, 42" PROSEAR		27,36	10077	GAS COLLECTOR BOX, 27",36" ONLY
	L54	80170	FIREBOX ASSY, 54" PROSEAR	47	30,42,54	30485	H-BURNER (BRASS)
	L54/30	80113	FIREBOX ASSY, 54/30"		27,36	11012	H-BURNER (BRASS)
22	ALL	20087	ORIFICE,SMOKER, NG (#68 SHORT)	48	30,42,54	20062	SMOKER BURNER, 16"
	ALL	20088	ORIFICE,SMOKER, LP (#77 SHORT)		L36	20061	SMOKER BURNER, 14"
	L27,L36	13013	ORIFICE,BURNER, NG (#41 SHORT)	49	PS MODELS	31885	PROSEAR BURNER
	L27,L36	13019	ORIFICE,BURNER, LP (#53 SHORT)	49A	PS MODELS	31256	SCREEN REPLACEMENT, PROSEAR BURNER
	30,42,54	30329	ORIFICE,BURNER, NG (#41 LONG)	50	30,42,54	80015/80364	BRIQUETTE TRAY (30", 42", 54") or ASS'Y
	30,42,54	30328	ORIFICE,BURNER, LP (#53 LONG)		42,54	80033/80365	BRIQUETTE TRAY, NARROW (42",54") or ASS'Y
	PROSEAR	13015	ORIFICE,BURNER, NG (#44 SHORT)		27,36	80232/80363	BRIQUETTE TRAY (27", 36") or ASS'Y
	PROSEAR	13020	ORIFICE,BURNER, LP (#54 SHORT)	51	ALL	90053	BRIQUETTES, 35 PER BOX
	30,36,54	13016	ORIFICE, IR ROTIS., NG (#50 SHORT)	52	ALL	80136	ROTISERIE INTERNAL HARNESS W/JACKS
	30,36,54	13021	ORIFICE, IR ROTIS., LP (#57 SHORT)	53	ALL	80206	LIGHT SWITCH INTERNAL HARNESS + SWITCH
	L27	13016	ORIFICE, IR ROTIS., NG (#50 SHORT)	54	ALL	31209	DUAL TRANSFORMER
	L27	13021	ORIFICE, IR ROTIS., LP (#57 SHORT)	55	ALL	31170	ROTISERIE EXTERNAL CORD
	L42	30470	ORIFICE, IR ROTIS., NG (#48 SHORT)	56	L27	10063	HOOD HANDLE, 27"
	L42	31342	ORIFICE, IR ROTIS., LP (#56 SHORT)		L30	30116	HOOD HANDLE, 30"
23	ALL	20063	SMOKER FLEX TUBE, 12 IN.		L36	10064	HOOD HANDLE, 36"
23A	L27	80143	ELECTRODE KIT, 27" NON-IR		L42	30117	HOOD HANDLE, 42"
	L27R	80144	ELECTRODE KIT, 27" IR		L54	31415	HOOD HANDLE, 54"
	L30	80146	ELECTRODE KIT, 30" NON-IR		L54/30	30116	HOOD HANDLE, 54/30"
	L30R	80147	ELECTRODE KIT, 30" IR	57	ALL	11117	BRACKET FOR HOOD HANDLE
	L30PSR	80154	ELECTRODE KIT, 30" PROSEAR	58	ALL	20016	INSULATOR HOOD HANDLE
	L36R	80145	ELECTRODE KIT, 36" IR	59	ALL	31200	HOOD THERMOMETER
	L42R	80148	ELECTRODE KIT, 42" IR	60	L27	30756	SPIT ROD, 27"
	L42PSR	80155	ELECTRODE KIT, 42" PROSEAR		L30	20103	SPIT ROD, 30"
	L5430R	80149	ELECTRODE KIT, 54/30 W/SB		L36	30757	SPIT ROD, 36"
	L54PSR	80171	ELECTRODE KIT, 54" PROSEAR		L42	20104	SPIT ROD, 42"
24	ALL	20055	ROLLER BEARING		L54	31417	SPIT ROD, 54"
	ALL	14099	ROLLER BEARING SCREW,#10-24x3/4 PH FLAT		L54/30	20103	SPIT ROD, 54/30"
	ALL	20083	ROLLER BEARING NUT, #10-24 HEX	61	ALL	20014	SPIT ROD HANDLE
				62	L27	31067	SPIT FORK, 27" ONLY
					30,36,42,54	31563	SPIT FORK, 30", 36", 42", 54"